

BILL OF MATERIALS							
QTY	SHIP MRK	PC MRK	MATERIALS	LENGTH FT	IN	REV.	REMARKS
ONE	4A		COLUMN				
ONE		ma	TS6x6x ¹ / ₄	27	3 ¹⁵ / ₁₆		
ONE		p1	PL ³ / ₄ x12	1	0		
ONE		p2	PL ¹ / ₂ x8	1	0		
ONE		p3	PL ¹ / ₂ x22 ⁷ / ₈	3	1 ¹ / ₁₆		
ONE	4B		TS6x6x ¹ / ₄	21	8 ¹ / ₈		
ONE		p4	PL ¹ / ₂ x8	1	0		
ONE		p5	PL ¹ / ₂ x6 ¹ / ₂	1	0		
ONE		p6	PL ¹ / ₂ x22 ⁷ / ₈	3	3 ⁷ / ₁₆		
ONE	4C		COLUMN				
ONE		mb	TS8x8x ⁵ / ₁₆	51	6 ¹³ / ₁₆		
ONE		p7	PL ³ / ₄ x18	2	0		
ONE		p8	PL ¹ / ₂ x10 ⁷ / ₈	1	3 ¹ / ₁₆		
ONE		p9	PL ¹ / ₂ x9 ¹ / ₂	1	0 ¹ / ₂		
ONE		p10	PL ¹ / ₂ x8 ¹ / ₂	1	8 ⁷ / ₁₆		
ONE		p11	PL ³ / ₈ x3 ¹ / ₂	0	9 ¹ / ₄		
ONE	4D		TS3x3x ¹ / ₄	8	9 ³ / ₄		
ONE		p12	PL ³ / ₄ x9	0	9		

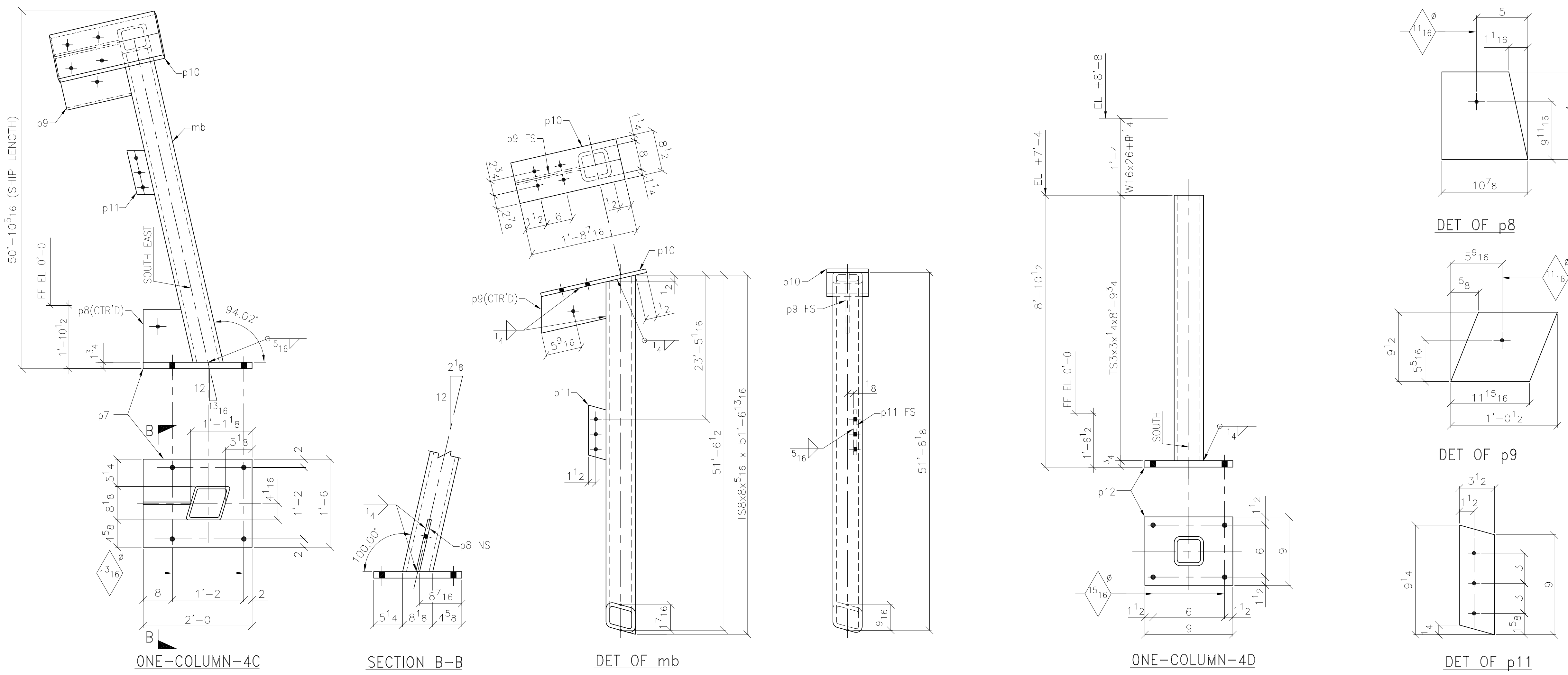

DATE	NO.	PER APPROVAL	REVISION/DESCRIPTION	IC
03-11-02	1		PER APPROVAL	IC

SHOP NOTES:
 1 ALL TS SHALL BE ASTM A 500, GRADE B, Fy=46 KSI
 2 ALL STEEL SHALL BE ASTM A 36 UNO
 3 WELDING ELECTRODES E70XX

CLEAN: SSPC-SP 6 PRIMER: STD SHOP HOLE: ¹³/₁₆Ø UNO

THESE DRAWINGS ARE TO THE BEST INTERPRETATION OF THE CONTRACT DRAWINGS, THEREFORE ANY ERRORS ON THE ORIGINAL DRAWINGS ARE NOT THE FAULT OF THE DETAILER OR STEEL FABRICATOR. IT IS THE RESPONSIBILITY OF THE APPROVER(S) TO VERIFY AND CORRECT ANY DIMENSIONS, MATERIALS, AND SECTION VIEWS. IF DIMENSIONS AND MATERIALS ARE NOT CORRECTED IN THE APPROVAL PROCESS, WE ASSUME THEY ARE CORRECT AND ACCURATE AND ARE NOT LIABLE FOR ANY EXPENSE FOR CORRECTIONS THEREAFTER.

FOR APPROVAL DATE 01/16/02	FOR CONST. AS NOTED	FOR CONST. DATE 03-11-02	SHEET # 4
----------------------------	---------------------	--------------------------	-----------

PROJECT: LUTHERAN CHURCH
 LOCATION: CENTER OF COMPASSION LUTHERAN CHURCH
 TITLE: COLUMNS